

SECTION Z-Z WITH PILOT CONNECTOR ARRANGEMENT.

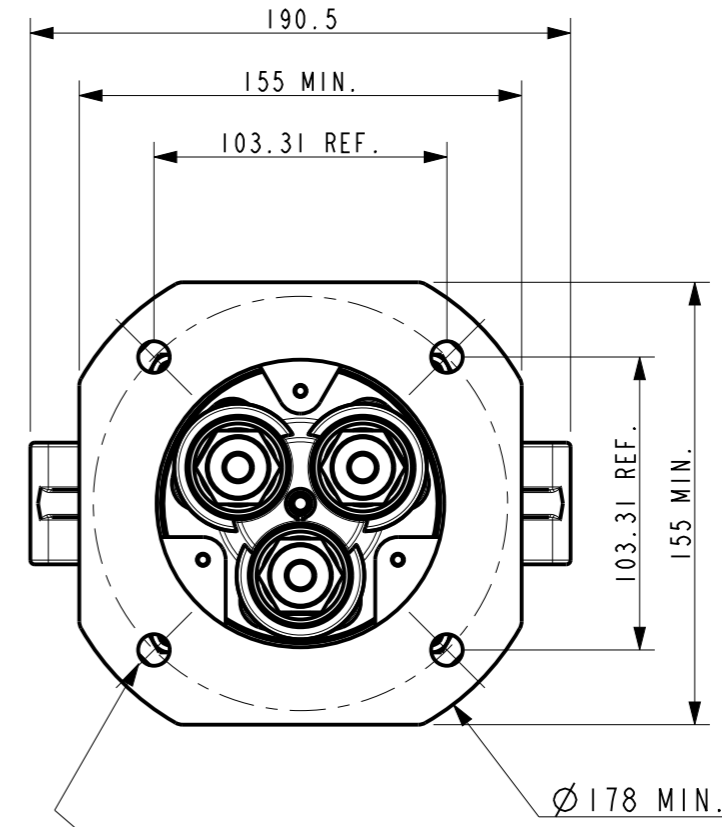

4 HOLES \varnothing 11.00/11.27
EQUA-SPACED ON A 146.1
P.C.D. CHAMFERED TO A
MAXIMUM OF \varnothing 11

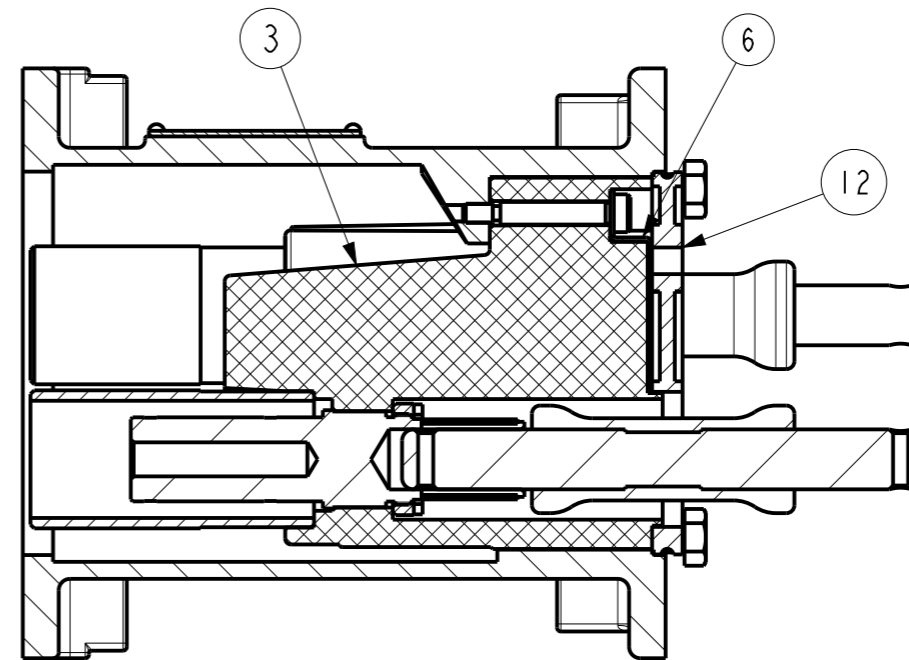

SECTION Z-Z WITHOUT PILOT CONNECTOR ARRANGEMENT

1. REF. Nos. 12 AND 13 ARE TO BE USED WHEN CONNECTING THE ADAPTOR TO A HALF COUPLER.

REF. No.	ITEM No.	DESCRIPTION	No. OFF	
1	50881A	ADAPTOR BODY ASSEMBLY - FLP	1	
2	50884A-	INSULATOR ASSEMBLY - WITH PILOT	1	
E	50887A	INSULATOR ASSEMBLY - WITHOUT PILOT	1	
3	50902-	CONTACT TUBE ASSY - FLP - CRIMPED	3	
	50898-	CONTACT TUBE ASSY - FLP - GRUBSCREWS	3	
4	4513	RETAINING RING	3	
5	50885A	PILOT CONTACT TUBE - FLP - SEE NOTE 2	1	
6	4786	SCREEN	1	
F	7	C12-18	SHOULDER SCREW - FLP	3
	8	C20-11	SPRING WASHER	3
	9	C11-20	INTERFACE CONNECTING SCREW	4
	10	C20-2	INTERFACE SPRING WASHER	4
	11	C10-6	INTERFACE CONNECTING NUT	4
G	12	38361409	SEAL RING WITHOUT PILOT HOLE	1
		38361410	SEALING RING WITH PILOT HOLE	1
	13	A7005552	INTER-CONNECTING PIN	3

DRAWING No.	ISSUE No.
CP301	1

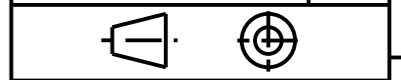

CERTIFICATE RELATED DRAWING

NO MODIFICATIONS PERMITTED WITHOUT THE APPROVAL OF THE TECHNICAL MANAGER

DO NOT SCALE

DIMENSIONS IN MILLIMETRES (mm)
MAXIMUM MACHINED SURFACE
TEXTURE μ m Ra 3.2
MACHINE WHERE MARKED THUS

DIMENSIONAL TOLERANCES UNLESS OTHERWISE STATED

TEST No.	PROCESS No.
200	---
DRAWN	AER
DATE	28/7/09
CHECKED	28/7/09 AER
APPROVED	28/7/09 AER
SCALE	1:4

DCR	DRN	28/7/09	AER
CHK	28/7/09	AER	APP
		28/7/09	AER

DRAWING INTRODUCED.

TYPE AFA33A STRAIGHT ADAPTOR.

Victor
Victor Products Limited
Unit 3A, Tyne Dock East Side,
Port of Tyne, South Shields,
Tyne and Wear, NE33 5SQ,
United Kingdom.

DRAWING No.	ISSUE No.
SHEET 1 OF 2	
CP301	1

DRAWING No.	ISSUE No.
CP301	1

CERTIFICATE RELATED DRAWING
 NO MODIFICATIONS PERMITTED WITHOUT THE APPROVAL OF THE TECHNICAL MANAGER

DO NOT SCALE

DIMENSIONS IN MILLIMETRES (mm)
 MAXIMUM MACHINED SURFACE
 TEXTURE $\mu\text{m Ra } 3.2$
 MACHINE WHERE MARKED THUS

ANGULAR TOLERANCES $\pm 1/2^\circ$
 DIMENSIONAL TOLERANCES UNLESS OTHERWISE STATED
 UPTO 6 ± 0.1
 OVER 6 UPTO 30 ± 0.2
 OVER 30 UPTO 100 ± 0.3
 OVER 100 UPTO 300 ± 0.5
 OVER 300 ± 0.8

TEST No.	PROCESS No.
200	---
DRAWN	AER
DATE	28/7/09
CHECKED	28/7/09 AER
APPROVED	28/7/09 AER
SCALE	1:4

DRAWING No.	ISSUE No.
SHEET 2 OF 2	
CP301	1

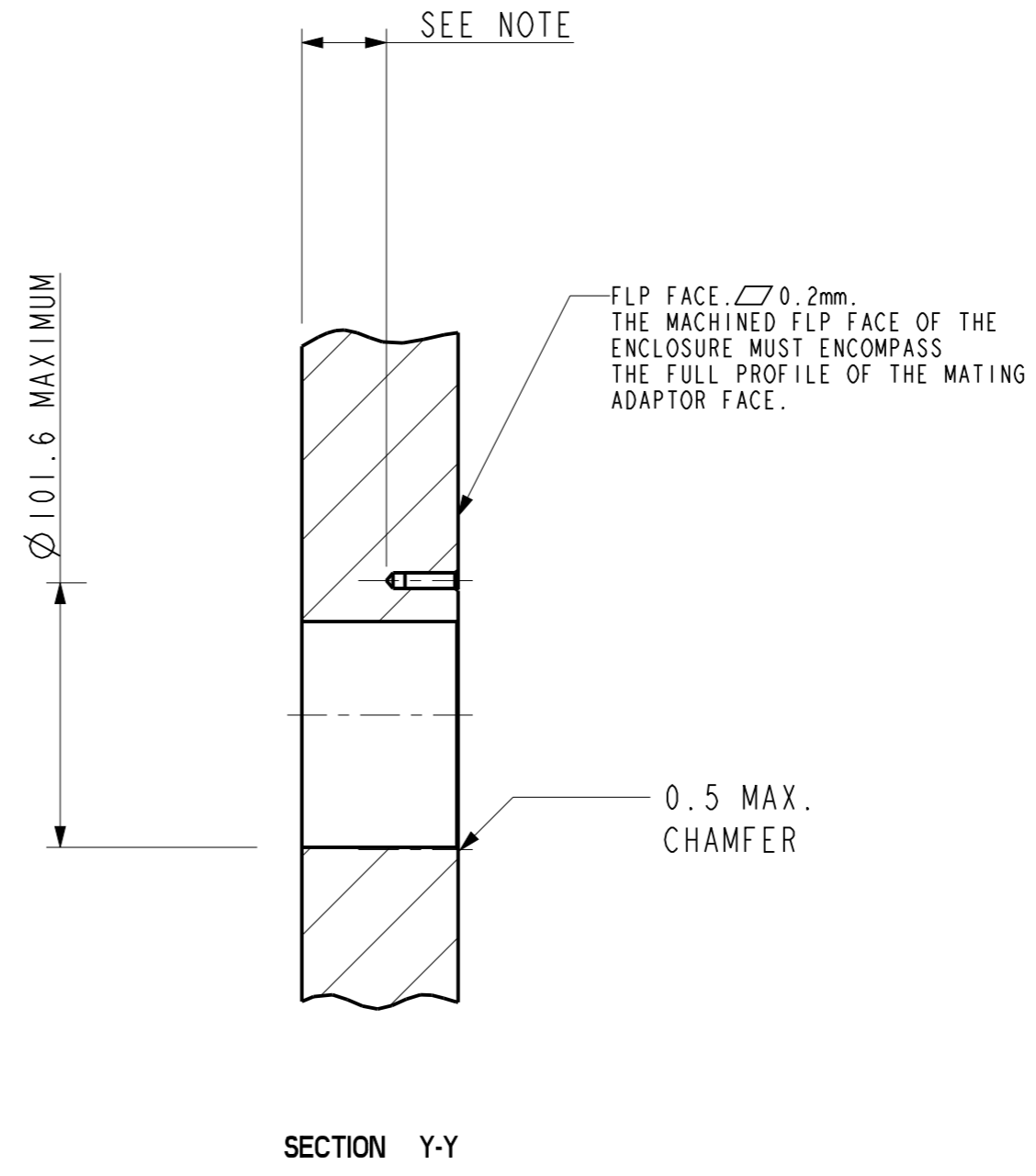
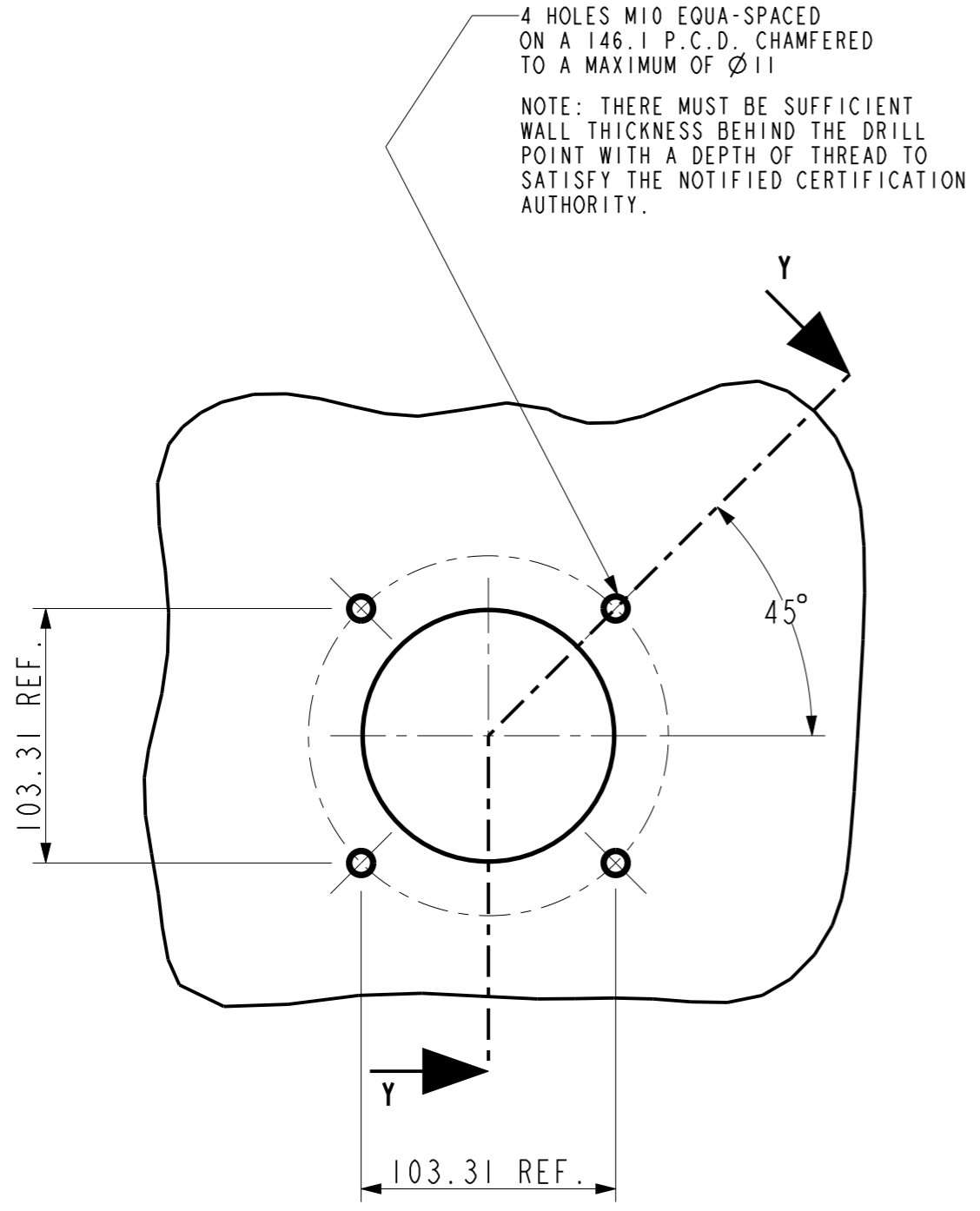

DCR 2009	DRN 28/7/09	AER
CHK 28/7/09	AER APP 28/7/09	AER

DRAWING INTRODUCED.

TYPICAL 3.3Kv INTERFACE FLANGE MOUNTING DETAILS.

Victor Victor Products Limited
 Unit 3A, Tyne Dock East Side,
 Port of Tyne, South Shields,
 Tyne and Wear, NE33 5SQ,
 United Kingdom.